

Telephone:
Fax:
VAT Registration No.:

Installation

Installation

1. Ensure timing marks aligned [2] & [3].
NOTE: Engines without crankshaft sprocket timing mark: Align crankshaft keyway with raised cast section.
2. 1,4 engines with distributor: Auxiliary shaft sprocket dowel pin at 2 o'clock [5]. Distributor rotor arm aligned with No.4 HT lead.
3. If fitted: Ensure camshaft position (CMP) sensor set at timing mark [9]. If not: Adjust auxiliary shaft sprocket.
4. Fit timing belt. Ensure belt is taut between sprockets.
5. Fit tensioning tool to tensioner pulley [8]. Tool No. 1860745100/200 [10]. Use tool without weight fitted.
6. Fit crankshaft pulley [7]. Tighten nut. A - Delta: 155 Nm. B - Dedra: 190 Nm.
7. Turn crankshaft two turns clockwise to TDC.
NOTE: If scale bar moves from the horizontal: Reset scale bar and repeat tensioning procedure.
8. Tighten tensioner nut to 44 Nm [8].
9. Install components in reverse order of removal.

Manufacturer: Lancia
Engine code: 159B9.000
Tuned for: R-Cat

Model: Dedra (94-99) 1,6
Output: 66 (90) 5750
Year: 1994-95

© Autodata Limited 2007
19.12.2007
V6.410- ***/Autodata***

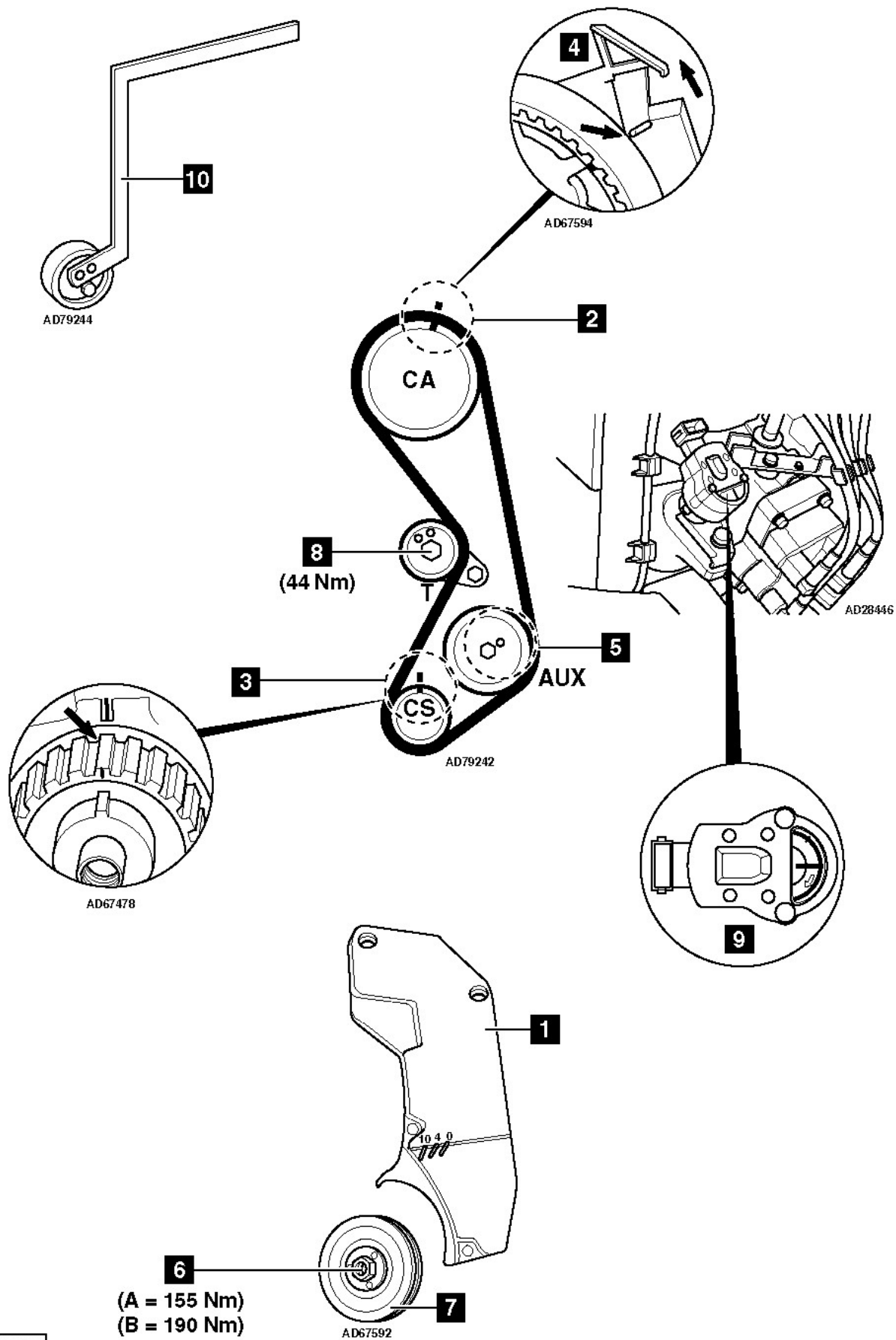

AD18419

Manufacturer: Lancia
 Engine code: 159B9.000
 Tuned for: R-Cat

Model: Dedra (94-99) 1,6
 Output: 66 (90) 5750
 Year: 1994-95

© Autodata Limited 2007
 19.12.2007
 V6.410- **/Autodata**